

Year 6 Residential Trip 2026

Monday 1st – Wednesday 3rd June 2026

Final Information Meeting



**BRENSCOMBE
OUTDOOR CENTRE**

Leading in outdoor education since 1992

- Residential & Day Courses
- Schools & Young People's Groups
- Corporate Development Programmes



01929 481 222
www.brenscombeoutdoor.co.uk



Last Year's Pics...

<https://www.westbyfleetjunior.org.uk/gallery/?pid=3&gcatid=1&albumid=273>



Contact Details

- Address:

Brenscombe Outdoor Centre

Studland Road

Corfe Castle

Wareham BH20 5JG

- Web address: <https://www.brenscombeoutdoor.co.uk/>

Location

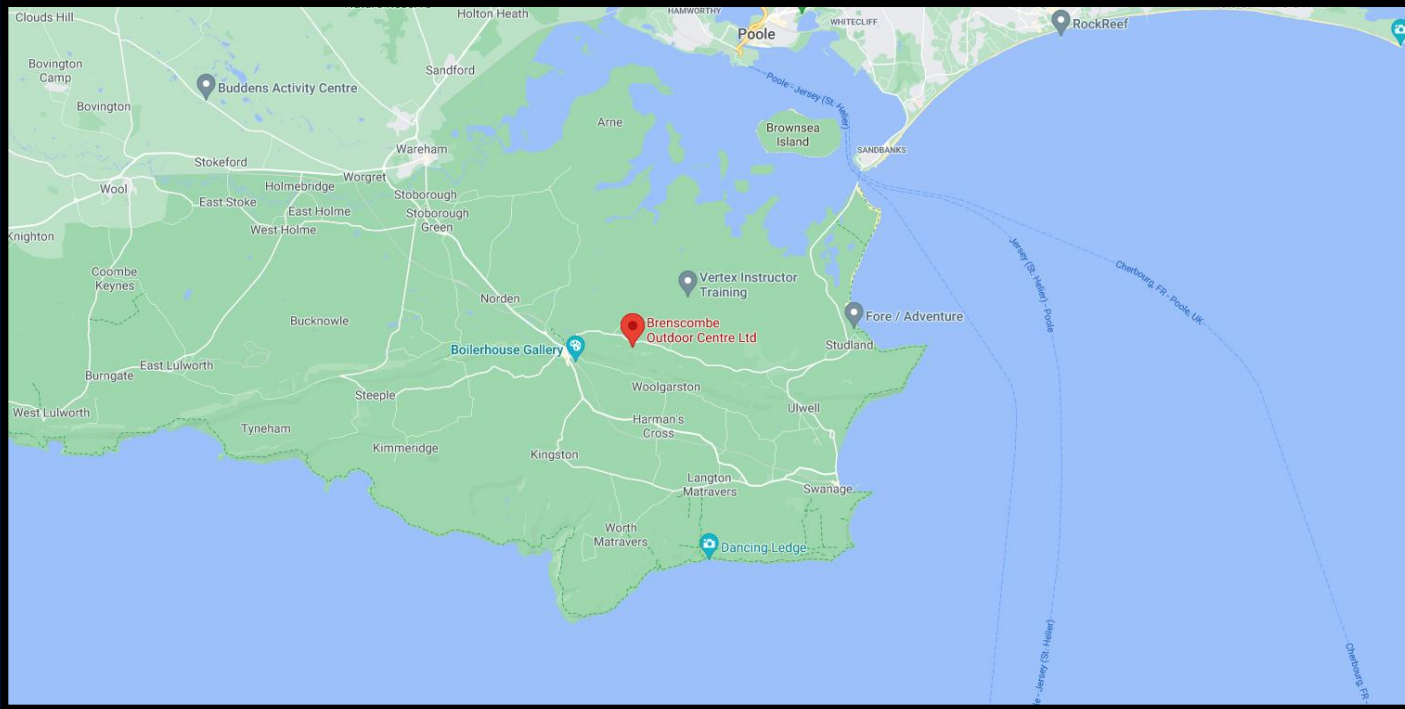

Activities



Our Timetable

Day	B/Fast	Morning	Lunch	Afternoon	Dinner	Evening
Day 1	-	Arrive at Centre 1030 Introductions, settle in & normal safety procedures	Own Packed lunch	Archery, Air Rifle and Catapult Challenge	1800	Murder Mystery Challenge
Day 2	0815	Kayaking and Raft Building at Cleavel Point 0900 Transport	Packed Lunch	Big Canoe in Poole Harbour 1630 Transport	1800	Sports Evening
Day 3	0815	Strip beds & clear rooms Orienteering to Corfe Castle	Packed Lunch	Certificates, Farewells and Departure 1330		

What you need to bring...



The trip requires the following kit list, with all clothing and personal items clearly named please.

SUITCASE: To include 3 days of sports/casual clothing:

Please note: there is no storage space in the children's dormitories so they will be expected to take everything out of their suitcases. We would recommend packing cubes, or similar, to keep everything together, obviously all clearly named!

- T-shirts, shorts (knee length), trousers, tracksuit bottoms, jumpers, leggings and include at least 1 long sleeved T-shirt. We recommend that children do not bring jeans as these are uncomfortable when wet and are also not always easy to move around in.
- Underwear and socks (more than you need for 3 days)
- Pyjamas
- Slippers, or a different pair of shoes for inside only (sliders etc.)
- Bath towel
- Swimming costumes/trunks
- Trainers, casual shoes
- Wellies (or another pair of shoes that you don't mind getting wet or muddy)
- Warm comfy clothes for evening activities
- Washbag with toiletries: hairbrush, soap, shampoo, toothbrush, toothpaste, deodorant - roll on please (**aerosols not allowed**)
- Waterproof coat
- Named Black Bin Liner (for damp/wet clothes)

SMALL RUCK-SACK: which **MUST** contain:

- Water bottle (filled - just for first day)
- Packed lunch (no hard containers) and two snacks (just for first day)
- **Baseball hat/sun hat**
- Lightweight waterproof jacket
- **Sun block**

ITEMS YOU MAY WISH TO BRING

- Reading book (e-readers are allowed but at owner's risk and with no Internet connections)
- Note book
- Card games
- Mini board games (travel editions)
- Pens and pencils
- Torch
- Clock for your room

ITEMS NOT ALLOWED

- Mobile phone
- Personal Electronic Devices, including Smart watches/Apple Air Tags & other tracking devices
- IPODs / MP3 players
- Electronic games / players etc.
- Expensive cameras
- Expensive clothing
- Expensive jewellery
- Expensive anything
- Food, sweets or drinks

When deciding what you need/want to bring, please check the weather forecast before packing your bag.

Medication

- If applicable, any named medicines required for the duration with full dosage instructions, **all medicines must be in original packaging with the chemist dispensing label if prescription medication.**
- Travel sickness medication must be taken at the required time before we leave school.
- Any medication needed for the journey home must be clearly labelled, with required timings of when to take medication.
- The medical form has already gone home and should have been returned.



Accommodation

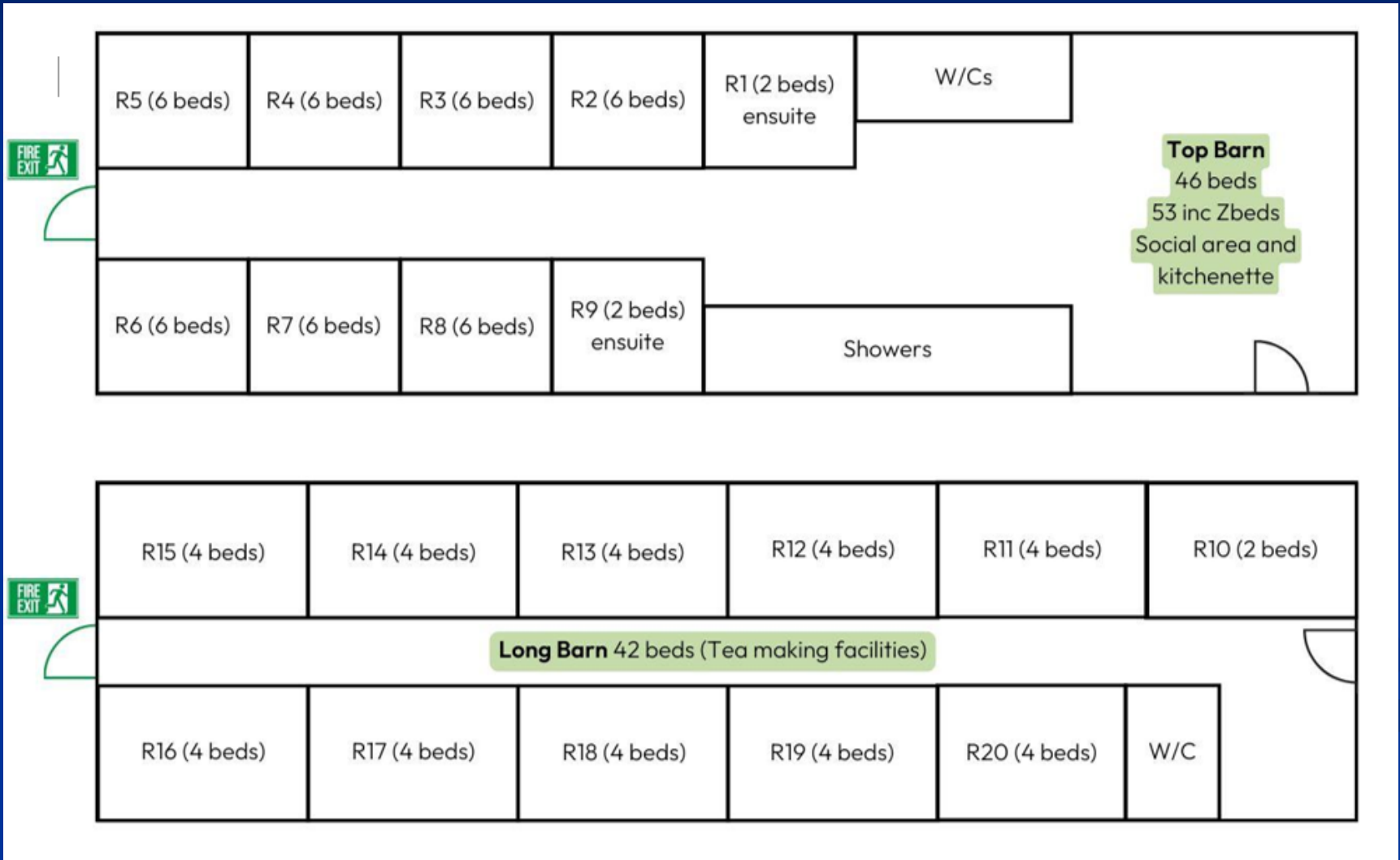

Accommodation



Accommodation



Timings: Leaving

- Children to arrive at school at **6:45am**.
- Come into school via the main gate and wheel bags down to the playground past Snowdon class.
- Medications to be signed in with **Mrs Suddaby and Miss Barrett**.
- Parents must stay within the designated waiting area.
- Coach will be leaving school at **7:15am**.



Timings: Returning

- Due to leave Brenscombe at 1:30pm – we will inform the office when we have departed and they will then let you know.
- We will then let you know an approximate arrival time once we know what the traffic is like.
- We should due back by 4:00pm – we will keep you updated on the day.



Other information:

- Your child will require a packed lunch and two snacks for the outward journey – no nuts!
- They need a water bottle that they can use during the week. If you would like to provide two, this is fine, as we will not have opportunities to keep washing them.
- Please ensure you have your phone readily available in case we need to get in contact with you. If there is any sickness then you will be required to collect your child.





Dear Parents/Guardian,

West Byfleet Junior School Residential Behaviour Agreement

Please look through the following expectations with your child:

1. Treat all those around you (children and adults) with kindness.
2. Listen carefully to instructions from all adults.
3. Make sure you are always on time to meeting points and organised.
4. Settle down to sleep when asked.
5. Stay quiet and remain in your rooms until morning wake up time (your adults will tell you when this is), unless there is an emergency.
6. Do not go into each other's bedrooms.
7. Shower during your stay and look after yourself by eating and drinking properly.
8. Look after your own belongings – make sure they are named and you keep them safe.
9. No sweets, snacks or drinks from home to be brought. You will be provided with lots of yummy food.
10. No mobile phones, tablets, laptops or any other device with internet capability.
11. You may bring a digital or disposable camera but please ensure these photos are not shared online.
12. You may also bring an e-reader (Kindle) with you that does not have internet connectivity. However, it is your responsibility to look after it.

If there is unacceptable behaviour whilst on the trip the following consequences may be put in place:

- Early bedtime
- Time out of evening activities
- Time out of main activities

If behaviour does not improve or puts others in danger, parents will be contacted.

If behaviour still does not improve or puts others in significant danger, then the child will unfortunately be sent home (without a refund).

Please sign below to confirm:

- ✓ I have read and discussed with my child the residential behaviour agreement.
- ✓ I agree with the behaviour agreement.
- ✓ My child agrees with the behaviour agreement.

Name of child: _____ Class: _____

Parent Signature: _____ Child's signature: _____

Behaviour Agreement...



Any Questions

